



Important: Verify your students Information

(Required for ALL students)

Using Online Registration Accessed through the Parent Portal

Willmar Public Schools uses an online registration system for parent/guardians to verify their student's information that is required to be completed before the students start school. The online registration yearly verification is accessed through your Willmar Public Schools parent portal account.

If you do not have one or do not remember your login credentials please email Willmar Schools at parentportal@willmar.k12.mn.us and we will respond to help you get the information to set up your account or send you your login credentials to access the online registration that will be opened up to all parent/guardians August 1st. Any questions, feel free to also email parentportal@willmar.k12.mn.us.

Steps to access and verify your student's information:

Login to your parent portal:

- Best if logged in on a computer or iPad
- go to www.willmar.k12.mn.us
- click **Parents**,
- then click "**Infinite Campus Login**"

1

2

Once logged into the parent portal,
Click **More** then click **Online Registration**

3

Click **Start** on Existing Student Registration



Click **Begin Registration**

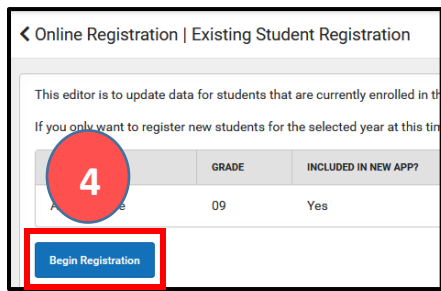

Select **language preferred**



Type your name and click **Submit**

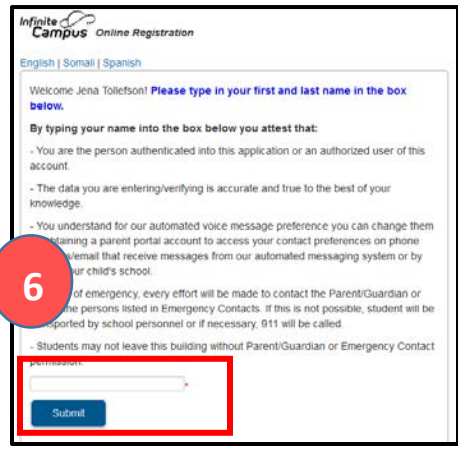

Click Here to Begin

7



Once **Submit** is clicked, you are done.

9

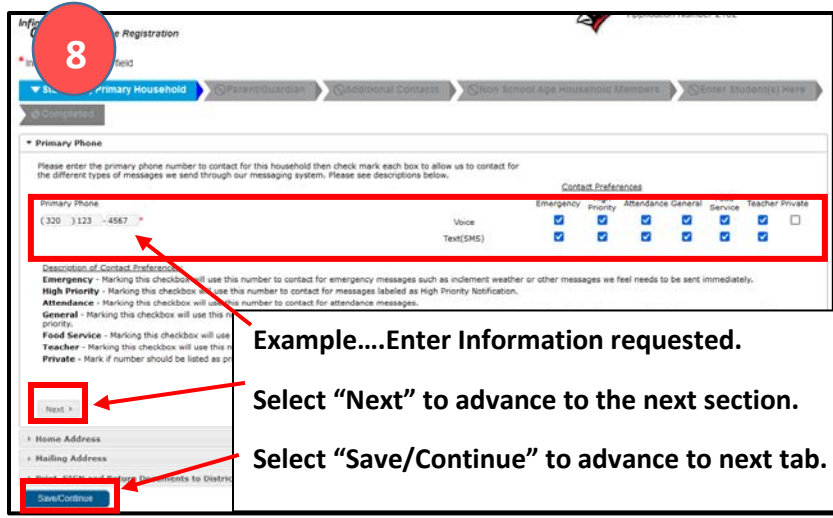

Example....Enter Information requested.

Select "Next" to advance to the next section.

Select "Save/Continue" to advance to next tab.

Importante: Verifique la información de sus estudiantes

(Requerido para TODOS los estudiantes)

Uso del registro en línea al que se accede a través del Portal para padres

Las Escuelas Públicas de Willmar utilizan un sistema de registro en línea para que los padres/tutores verifiquen la información de sus estudiantes que se requiere completar antes de que los estudiantes comiencen la escuela. Se accede a la verificación anual de registro en línea a través de su cuenta del portal para padres de las Escuelas Públicas de Willmar.

Si no tiene uno o no recuerda sus credenciales de inicio de sesión, envíe un correo electrónico a las Escuelas de Willmar a parentportal@willmar.k12.mn.us y le responderemos para ayudarlo a obtener la información para configurar su cuenta o enviarle sus credenciales de inicio de sesión para acceder al registro en línea que se abrirá a todos los padres/tutores el 1 de agosto. Cualquier pregunta, no dude en enviar también un correo electrónico parentportal@willmar.k12.mn.us.

Pasos para acceder y verificar la información de su estudiante:

Inicie sesión en su portal para padres:

- Mejor si inicia sesión en una computadora o iPad
- Ir a www.willmar.k12.mn.us
- Hacer clic **Parents**, (Padres)
- Hacer clic “**Infinite Campus Login**” (Campus Infinito Iniciar sesión)

1.

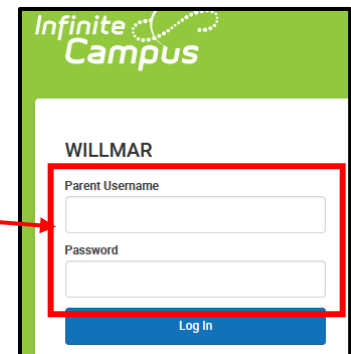

2.

Una vez que haya iniciado sesión en el portal para padres,
Hacer clic **More (Mas)** Luego hacer clic **Online Registration (Registro en línea)**

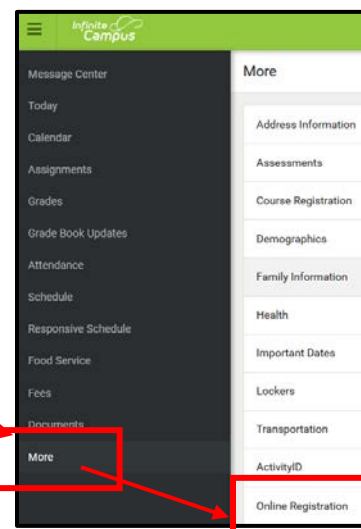

3

Hacer clic **Start** (Comienzo) sobre el registro de estudiantes existentes



4. Hacer clic **Begin Registration** (Iniciar registro)

5. Seleccione **language preferred** (idioma preferido)

6. **Escriba su nombre** y hacer clic **Submit** (Enviar)

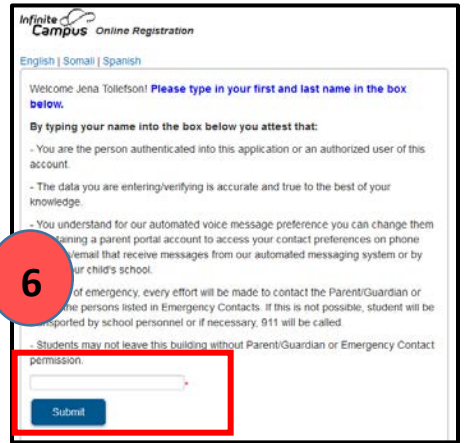
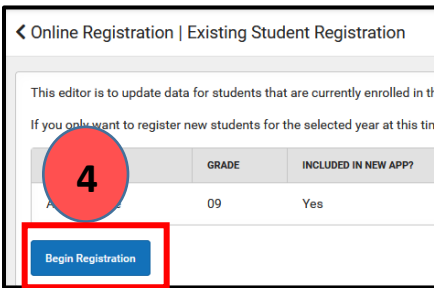

Haga clic aquí para comenzar

7

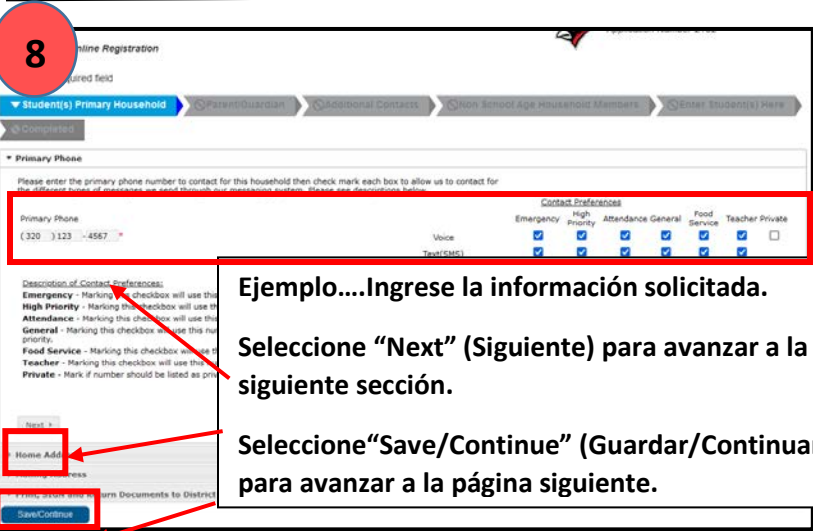
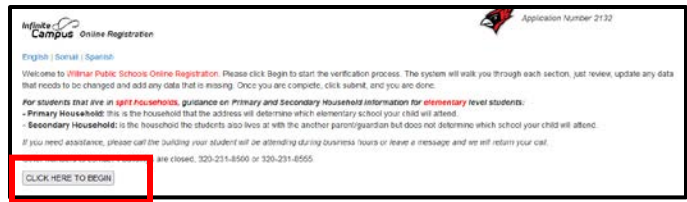

Ejemplo....Ingrese la información solicitada.
 Seleccione "Next" (Siguiente) para avanzar a la siguiente sección.
 Seleccione "Save/Continue" (Guardar/Continuar) para avanzar a la página siguiente.

9

Una vez que se hace clic en **Submit** (Enviar), ya a terminado

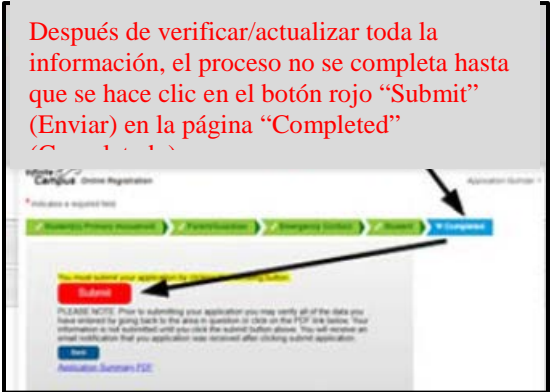



Muhiim: Xaqiiji Macluumaadkaaga Ardaydaada

(Waajib ku ah ardayda oo DHAN)

Isticmaalidda Diiwaangalinta Onlaynka ah Laga galo Boortalka Waalidka

Dugsiyada Dadwaynaha Willmar waxay isticmaalaan nidaam diiwaangalin oo onlayn ah si waalidka/masuuladu u xaqiijiyaan macluumaadka carruurtooda ee looga baahan yahay inay buuxiyaan kahor inta ardaydu ayna dugsiya bilaabin. Xaqiijinta sanadlaha ah ee diiwaangalinta onlaynka ah waxa laga heli karaa xisaabta boortalka waalidka ee Dugsiyada Dadwaynaha Willmar.

Haddii aadan lahayn ama aadan xasuusan macluumaadka aad ku gali lahayd, fadlan iimayl u dir parentportal@willmar.k12.mn.us waananu kuu jawaabi doonaa si aanu kaaga caawino inaad hesho macluumaadka si aad u samaysato xisaabtaada ama soo dir macluumaadkaaga galitaanka si aad u gali karto diiwaangalinta onlaynka ee u furti doona dhammaan waalidka/masuulada Agoosto 1^{da}. Wixii su'aalo ah, sidoo kale iimayl ugu soo dir parentportal@willmar.k12.mn.us.

Tallaabooyinka galitaanka iyo xaqiijinta macluumaadka ilmahaaga:

Gal boortalkaaga waalidka:

- Waxa ugu fiican haddii aad ka gasho kombiyuutar ama iPad
- booqo www.willmar.k12.mn.us
- guji **Parents**,
- kadib guji “**Infinite Campus Login**”

1

2

Markaad gasho boortalka waalidka,
Guji **More** kadib guji **Online Registration**

3

Guji *Start* on Existing Student Registration

< More | Online Registration

NAME	STATUS	ACTION
22-23 New Student Registration		Start
22-23 Existing Student Registration	NOT STARTED	Start

Guji *Begin Registration*

< Online Registration | Existing Student Registration

This editor is to update data for students that are currently enrolled in this year. If you want to register new students for the selected year at this time...

NAME	GRADE	INCLUDED IN NEW APP?
Abdirahman	09	Yes

Begin Registration

Dooro *language preferred*

5

Infinite Campus Online Registration

English | Somali | Spanish

Please pick your preferred language.

Fadlan dooro luuqada aad doorbideyso.

Favor de elegir su idioma preferido.

Magacaga qor oo guji *Submit*

Infinite Campus Online Registration

English | Somali | Spanish

Welcome Jena Tollefson! Please type in your first and last name in the box below.

By typing your name into the box below you attest that:

- You are the person authenticated into this application or an authorized user of this account.
- The data you are entering/verifying is accurate and true to the best of your knowledge.
- You understand for our automated voice message preference you can change them by logging into a parent portal account to access your contact preferences on phone or email that receive messages from our automated messaging system or by contacting your child's school.
- In the event of an emergency, every effort will be made to contact the Parent/Guardian or the persons listed in Emergency Contacts. If this is not possible, student will be transported by school personnel or if necessary, 911 will be called.
- Students may not leave this building without Parent/Guardian or Emergency Contact permission.

Submit

Click Here to Begin

7

Infinite Campus Online Registration

Application Number: 2132

English | Somali | Spanish

Welcome to Wilmar Public Schools Online Registration. Please click Begin to start the verification process. The system will walk you through each section, just review, update any data that needs to be changed and add any data that is missing. Once you are complete, click submit, and you are done.

For students that live in split households, guidance on Primary and Secondary Household information for elementary level students:

- Primary Household: This is the household that the address will determine which elementary school your child will attend.
- Secondary Household: is the household the students also lives at with the another parent/guardian but does not determine which school your child will attend.

If you need assistance, please call the building your student will be attending during business hours or leave a message and we will return your call.

After hours assistance is available. Our support lines are closed, 320-231-6500 or 320-231-6555.

CLICK HERE TO BEGIN

8

Infinite Campus Online Registration

Primary Household

Primary Phone

Please enter the primary phone number to contact for this household then check/mark each box to allow us to contact for the different types of messages we send through our messaging system. Please see descriptions below.

Primary Phone: (320) 123-4567

Contact Preferences:

Emergency	Priority	Attendance	General	Service	Teacher	Private
<input checked="" type="checkbox"/>	<input checked="" type="checkbox"/>	<input checked="" type="checkbox"/>	<input checked="" type="checkbox"/>	<input checked="" type="checkbox"/>	<input checked="" type="checkbox"/>	<input type="checkbox"/>

Description of Contact Preferences:

- Emergency** - Marking this checkbox will use this number to contact for emergency messages such as inclement weather or other messages we feel needs to be sent immediately.
- High Priority** - Marking this checkbox will use this number to contact for messages labeled as High Priority Notification.
- Attendance** - Marking this checkbox will use this number to contact for attendance messages.
- General** - Marking this checkbox will use this number for general messages.
- Food Service** - Marking this checkbox will use this number for food service messages.
- Teacher** - Marking this checkbox will use this number for teacher messages.
- Private** - Marking this checkbox will use this number for private messages.

Next

Save/Continue

Tusaale....Gali Macluumaadka la codsaday.

Dooro "Next" si aad qaybta xigta ugu gudubto.

Dooro "Save/Continue" si aad ugu gudubto taabka/shaashadda xigta.

9 Markaad *Submit* gujiso, waad dhammaysay.

After verifying/Updating all information, the process is not complete until the red 'Submit' button has been clicked on the 'Completed' tab.

Submit